

# Project profile

## Memorial landscapes

### The Falklands Memorial Chapel, Pangbourne, Berkshire

Opened in March 2000, the chapel for the Falkland Island Memorial Chapel Trust was built to commemorate those who lost their lives in the Falklands War of 1982.

The chapel was designed by Crispin Wride Architects, while the landscape setting was designed by the Terra Firma Consultancy, using simple lines and a restrained planting palette to encourage quiet contemplation. Landscape construction was completed by Country Landscapes.

The chapel is also an assembly space for the 550 students of Pangbourne College, in whose grounds the chapel is sited. Both the building and the grounds had to resolve the contradiction between the two functions of a small shrine and a large meeting place. The building evokes a sense of peace and protection through its two arcs of masonry, symbolising cupped hands raised in prayer or protecting those who mourn within.

To the west of the chapel, a lawn with gently scalloped landforms, punctuated with Antarctic beech trees (*Nothofagus antarctica*) follows the curve of the chapel wall. To the east the space is surfaced with gravel, with radiating bars of reconstructed granite extending the building's geometry across the space. Rocks similar to those found in the Falklands provide informal seating

beneath a copse of gleditsia. An old circular water tank to the south east has been transformed into a sunken memorial garden within a mound with banks of grasses on one side (*Miscanthus sinensis* 'Yakushima Dwarf', *Stipa tenuissima* and *Festuca glauca* 'Elijah Blue'). Yew and gleditsia are planted on the northern slope, underplanted with *Liriope muscari* and *pachysandra terminalis*. A curved stone seat within the sunken garden faces a small pool with a waterfall cascading from a black granite panel carved with a map of the Falkland Islands.

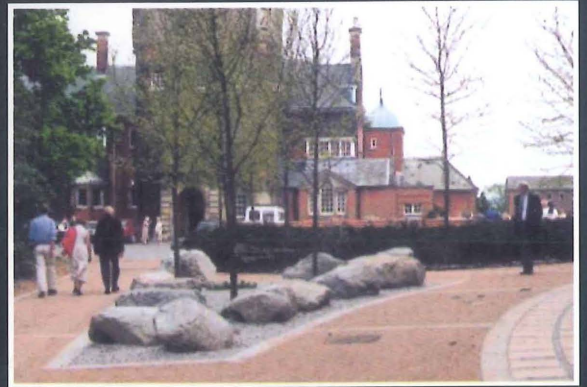

The external areas had to meet tight financial constraints and functional requirements, such as ease of maintenance, access and seating (while also bringing the scale and form of the new building into its surroundings). The plan is overlaid with symbolism: the geometry of the southern cross, the yew, traditionally associated with British churchyards, and the grasses, rocks and water of the south Atlantic. □

**Lionel Fanshawe** is the director of Terra Firma Consultancy.  
Email: <contact@terrafirmaconsultancy.com>.

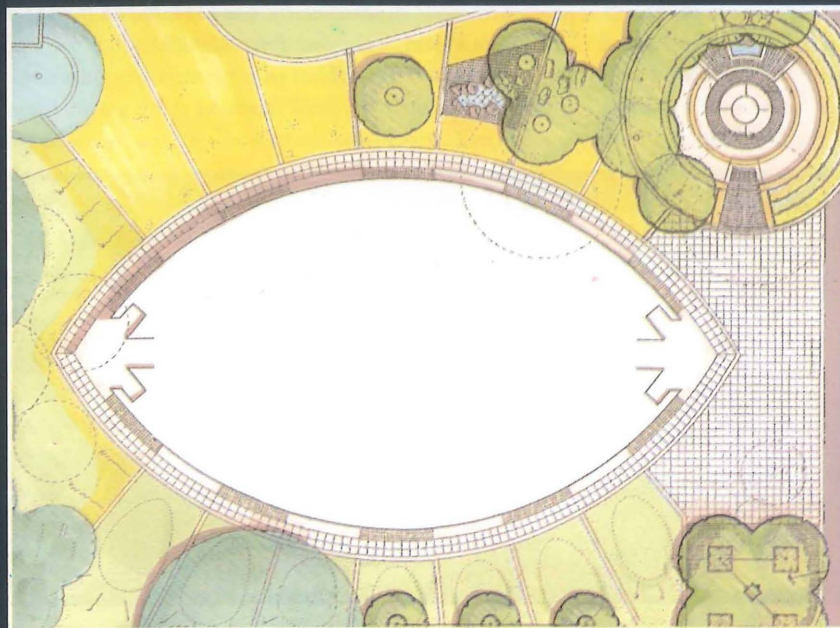

- ↑↑ Gleditsias were underplanted with yew, *Liriope muscari* and *Pachysandra terminalis*
- ↑ Boulders representing the Falklands landscape
- ↖↑ Water gushes past a stone map of the Falkland Islands
- ← Plan showing how the chapel relates to the sunken garden and surrounding landscape